



jordanfishwick

Downtown, Salford, M5 4YG
£1,050 Per Month

- Available Mid July
- Council Tax Band B
- Residents Gym and Spin Studio

Living Room/Kitchen

22'2" x 11'7"

Range of wall and base units with complimentary worktop over. Integrated fridge/freezer and dishwasher. Cooker with hob and extractor over. Spotlights. Laminate flooring throughout. TV and telephone point. Airing cupboard housing the washing machine.

Bedroom One

14'11" x 8'6"

Fitted carpet. Ceiling light. Window.

Ensuite

8'6" x 5'6"

Partially tiled. Low level W/C. Floating sink with mixer tap. Bath with mixer shower over. Vanity mirror.

Bedroom Two

14'11" x 8'6"

Fitted carpet. Ceiling light. Window.

- Two Double Bedrooms
- UNFURNISHED
- Cinema Room/ Work Space

Jack and Jill Bathroom

8'6" x 6'5"

Partially tiled. Low level W/C. Floating sink with mixer tap. Bath with mixer shower over. Vanity mirror.

Externally

Communal gardens. Lift to all floors. Concierge. Gym. Spin studio. Work space. Cinema Room.

Additional Information

- Two Bathrooms
- 24 Hour Concierge

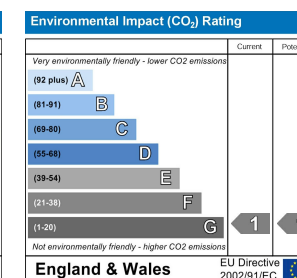
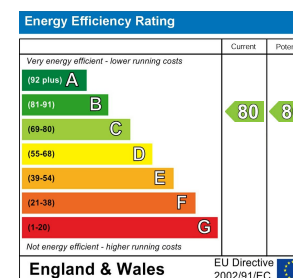

These particulars are believed to be accurate but they are not guaranteed and do not form a contract. Neither Jordan Fishwick nor the vendor or lessor accept any responsibility in respect of these particulars, which are not intended to be statements or representations of fact and any intending purchaser or lessee must satisfy himself by inspection or otherwise as to the correctness of each of the statements contained in these particulars. Any floorplans on this brochure are for illustrative purposes only and are not necessarily to scale

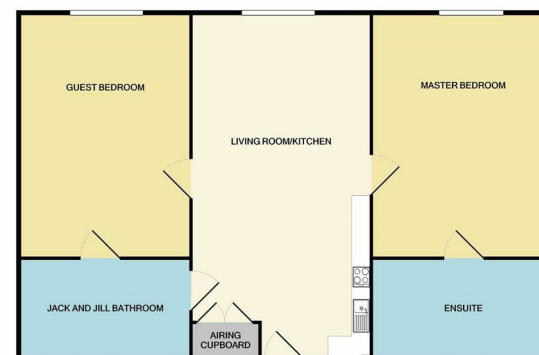

Measurements are approximate. Not to scale. Illustrative purposes only. Made with Metropac (2021)



These particulars are believed to be accurate but they are not guaranteed and do not form a contract. Neither Jordan Fishwick nor the vendor or lessor accept any responsibility in respect of these particulars, which are not intended to be statements or representations of fact and any intending purchaser or lessee must satisfy himself by inspection or otherwise as to the correctness of each of the statements contained in these particulars. Any floorplans on this brochure are for illustrative purposes only and are not necessarily to scale.

Offices at: Chorlton, Didsbury, Disley, Hale, Glossop, Macclesfield, Manchester Deansgate, Manchester Whitworth Street, New Mills, Sale, Wilmslow and Withington

68 The Arches, Whitworth St West, Manchester, M1 5WQ

0161 833 9499 opt 2

manchester@jordanfishwick.co.uk
www.jordanfishwick.co.uk